

GD-RI 2+2 A/4MI

GD LARGE DIAMETERS

Self-centering chuck
with 4 jaws by 2+2
hydraulically actuated plus
4 independent jaws manually actuated
Useful if required an increase
of clamping force
or for strong clamping on two levels

- Sizes achievable
up to \varnothing 7000 mm
- Automatic stroke
30 mm per jaw
- Combination feature
(manual independent
adjustment stroke 32 mm
per jaw)
- Manual independent stroke
50 mm each manual jaw
- Max. clamping force
per jaw 200 kN with 70 bar

LARGE DIAMETERS

GD-RI 2+2 A/4MI

Self-centering chuck with 4 jaws by 2+2 hydraulically actuated plus 4 independent jaws manually actuated
Useful if required an increase of clamping force
or for strong clamping on two levels

- **Control by hydraulic twin cylinder** with 2 independent pistons.
- **Device for stroke control** of each cylinder piston.

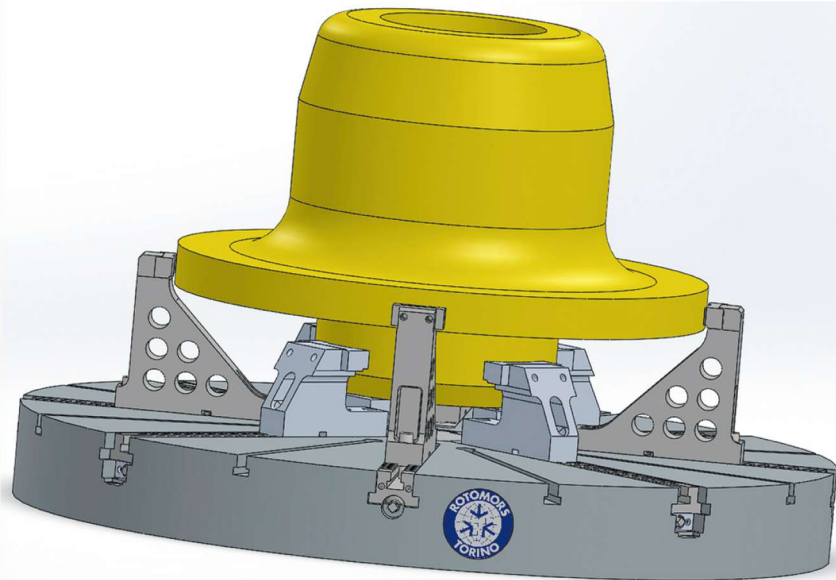
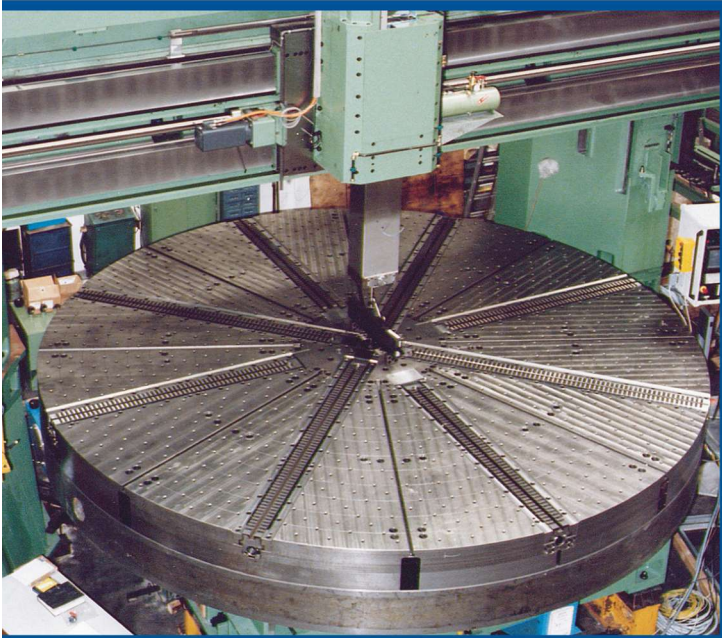

Optional devices

This type of **GD SELF-CENTERING LARGE DIAMETER CHUCK** can be arranged, on request, with following devices:

- **Protected guides** with oil wiper packing to eliminate impurities on jaw guide surface.
- **Forced lubrication**, lubrication and cleaning of all ways are assured by a manifold inserted in the rotating distributor.
- **Mechanical devices with balancing mass** to compensate centrifugal force.
- **Insert steel guides**, hardened and ground.
- **Jaws quick shifting system**.
- **ELECTRONIC CONTROL** total clamping force.
- **ELECTRONIC CONTROL** single jaw clamping force.

On request we can study customized solutions. Non-binding data/sketches, subject to modifications or technical improvements

ROTOMORS S.p.A.

Via A. Maserati già Via S. Paolo, 62/64
10095 Grugliasco - Torino (Italy)
☎ +39 011 78 57 57
info@rotomors.com

ROTOMORS FRANCE Sarl

7, Zone Artisanale Beptenoud Nord
38460 Villemoirieu (France)
☎ +33 4 741825 22
info@rotomors.fr

ROTOMORS GmbH

Albert-Einstein-Str. 2
70806 Kornwestheim (Deutschland)
☎ +49 7154 816 04 60
info@rotomors.de

